

RTLC Series

Application:

Crane, hoist, elevator load monitoring, tension measurement in any type of rope / cable base application

Option:

- ◆ Stainless steel construction
- ◆ Amplified output (4-20mA, 0-10V DC)

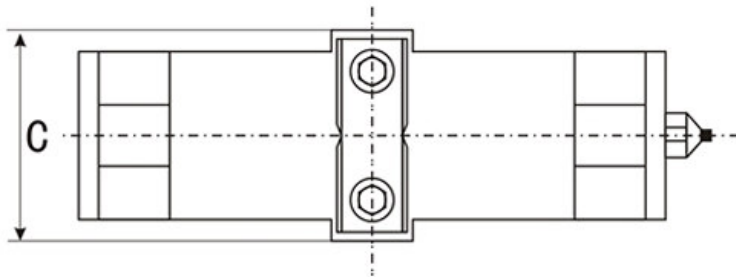
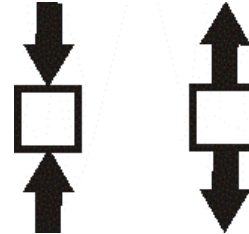
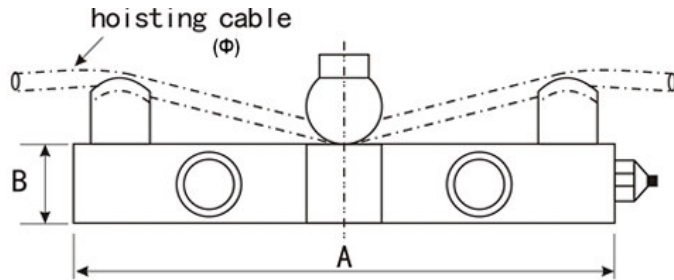
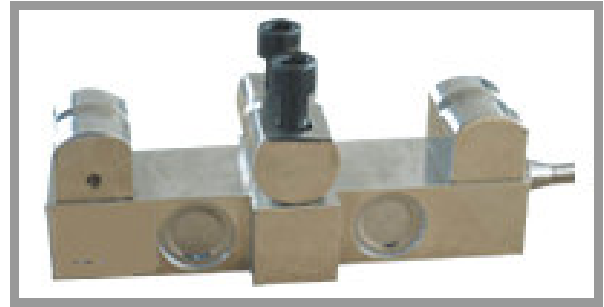

Dimensions in 'mm'				
Rated Load	Φ	A	B	C
1t	6 - 14	160	30	60
2t	10 - 18	160	30	60
5t	16 - 26	180	34	68
10t	24 - 36	200	40	80
20t	24 - 36	240	46	90

Technical Data:

Capacities	1, 2, 5, 10, 20 t
Sensitivity	2.0 ± 1% mV /V
Non-Linearity	± 0.5% FS
Hysteresis	± 0.5% FS
Repeatability	± 0.5% FS
Zero Balance	± 1% FS
Temp. effect span	± 0.05% FS/10°C
Temp effect zero	± 0.05% FS/10°C
Temperature compensated range	-10 ~ +55°C
Input resistance	400 ± 15Ω
Output resistance	350 ± 3Ω
Insulation resistance	> 2000 MΩ (@ 50V DC)
Safe overload	150% FS
Ultimate load	200% FS
Recommended excitation	10V (DC/AC)
Maximum excitation	12V (DC/AC)
Construction	Alloy Steel
Environmental protection	IP 65 (Hermetically Sealed)

Haris Sensor Technologies Private Limited

Row House No.11, Narayani C.H.S. Ltd., Sector 2, Airoli, Navi Mumbai - 400 708.
 TeleFax: +91-22-2779 6901 ~ 06 ✪ E-mail: harisent@vsnl.net ✪ Website: harissensor.com

HARIS